



The **DETEX System** is a unique product, this is the World's 1st Smoke Extractor without external air piping or ducting.

The **DETEX** is an innovative alternative solution that comes up to the usual smoke extraction technologies.

- Autonomous to make it working even after a power cut.
- Convenient for a simple installation
- Esthetically customizable for being integrated into your home or working offices.

#### SCOPE OF INSTALLATION:

- Residential Buildings (BH)
- Hospitals
- Buildings Receiving People (ERP)
- High Rise Building (IGH)
- Working Offices (ERT)
- Classified Buildings & Establishments
- Marine Vassels
- Naval Ships





## HOW IT WORKS?

- The DETEX is fitted with a DAAF and an filtration casing
- When the DAAF triggers, The DETEX starts extracting the air with an air flow of 192 m<sup>3</sup>/h, and at the same time treats the smoke and convert into ambient air while purifying it...

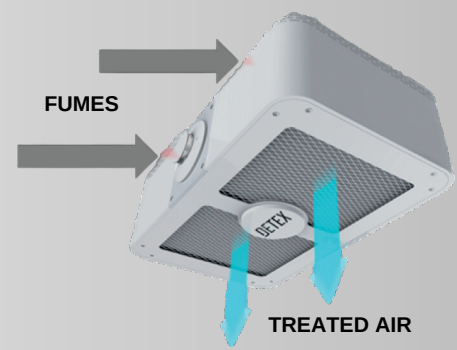

## REMINDERS

- 90% of deaths in the world are caused by smoke during fire incidents
- 75% of fires occur in the night
- Average time of intervention of fire fighters is 10-15 minutes

## EFFICIENCY: AIR FILTRATION / IMPROVEMENTS FOR ENVIRONMENT

- Sucks & holds smoke soots, consequently preventing intoxication (filtre 0,3p)
- Reducing the carbon dioxide by -31% • Reducing the carbon monoxide by -6%

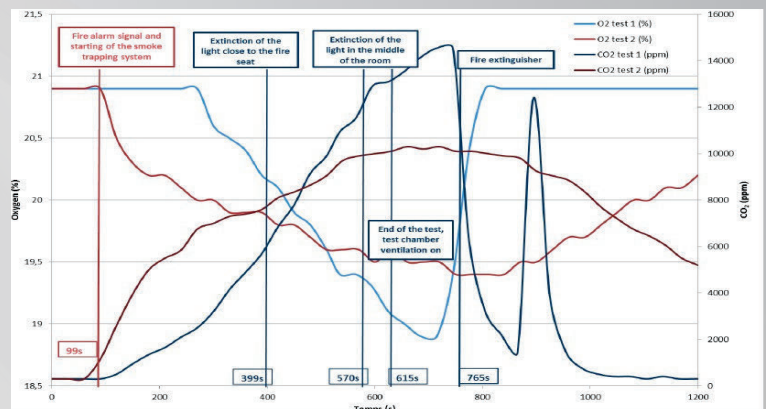

gas	Critical concentrations (mg/m <sup>3</sup> )	Critical concentrations (vppm)	Max reference test (vppm)	Max smoke evacuation test (vppm)	Efficiency of the smoke trapping system (%)
CO <sub>2</sub>	72000	36420	14900	10300	- 31%
CO	1380	1104	500	471	- 6%

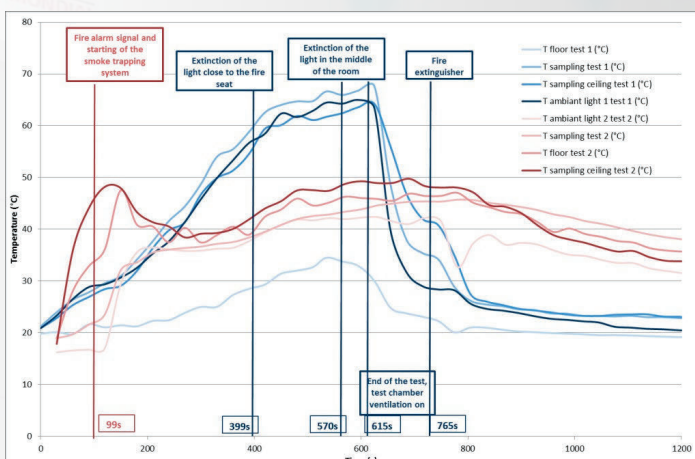

- Removes all hydrogen sulphide Lowering temperature of a smoke filled room by -30% (Significantly delaying the burning process of the room)
- Maintaining an acceptable oxygen rate of at least 19%
- Capability for dealing with a total air flow of 192m<sup>3</sup>/h increases visibility (Reducing panic effect)

# APPLICATIONS

In every place natural or mechanical smoke extraction system cannot be (or with difficulty) fitted or installed:

- Impossible/very difficult to set up a way to get smokes out towards walls or roof
- Impossible/very difficult to set up a air piping/ducting to drive the air out of the building

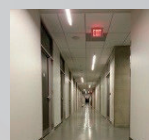

Horizontal Circulations



Cellars Circulations



EAS



Staircases

Installation of natural smoke extraction in a stairwell

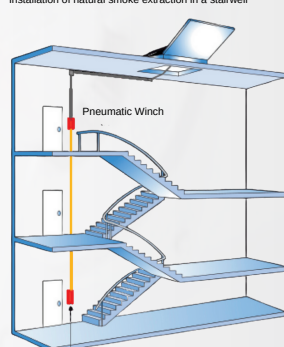

Installation of peer processing (DETEX) in a stairwell

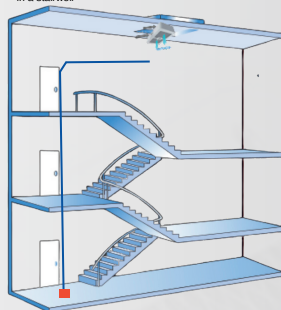

Single opening Box

**The installation requires the following:**

- No pipe/ducting for extraction
- No incoming air piping required

You just need a power supply 220V connected into an independent fuse

It can be autonomous or driven by a manual Release (ON/OFF)



Power supply: 220V-110V  
Backup battery: 12V 500mA-30min Approx.  
Battery: AGM S12V-7Ah FR  
Battery Load Indicator: sonor & visual alert via LEDs  
Filtration: Laminar Filters H13, filtration at 0,3 micrometers  
Polycarbonate VO glowing wire 960"  
Polyamide 30% fdv

Detector sensor: photo-electronic  
Alarm piézoélectrique alarm, intégré to the Vesta Detector.  
Signal Power: >85 dB(A) at 3 m and >94.5 dB(A) à 1 m.  
Automatic autotest: automatic testing the detector.  
the PCB electronic card & battery voltage

## Dimensions:

Model 1 (Standard): 460 x 354 x 165 mm

Net Weight: 7.5 kg

Model 2: 590 x 590 x 140 mm.

Net Weight: 18 kg

Optional Fittings: Integrated LED Lights,  
input-output connections to link it to a control panel, manual trigger switch.

## Certification:

Filter: EN 1822

Détector: NF-EN 14 604

Detex complete product/system: CE

Tests Conducted by: CRÉPIM (Europe)

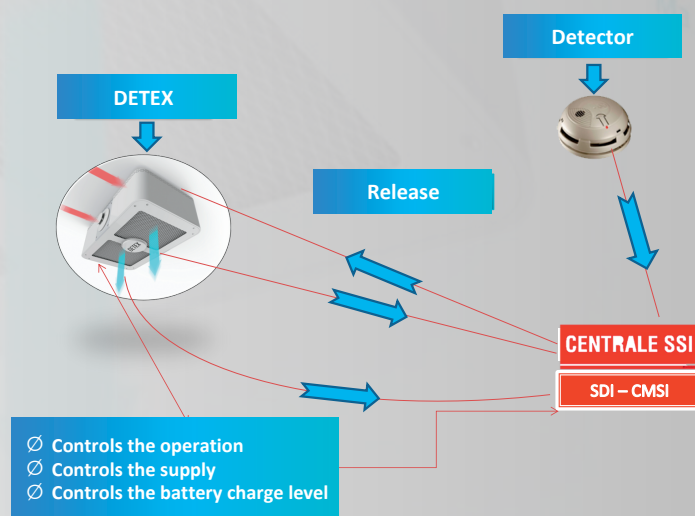





## Certifications:

- DAAF: Certified NF-EN14604
- Filters: Certified EN 1822
- Plastic Material Certificate: Polycarbonate VO 960"
- Detex: Certified CE
- Test results performed by CREPIM



## Le CREPIM: European Test Lab

- CREPIM has measured, certified & approved the DETEX performance
- CREPIM is recognized & accredited by the following OEMs:



Aéraulique Technologie Innovative  
Pvt. Ltd.

Head Office: C-98, Swaran Park, Udyog Nagar,  
Cement Godown Gali, Mundka, Near Rajdhani  
Park Metro Station, New Delhi-110041, India

M: +91 99144 55512

E-mail: [info@detexindia.com](mailto:info@detexindia.com)

Web: [www.detexindia.com](http://www.detexindia.com)



Homebiz Security  
Consultants

Head Office: Flat No. 8, 1st Floor, Eldeco Green Plaza,  
Sector H, Purania, Aliganj, Lucknow, India-226024

M: 0522 4004394, 9839009511

E-mail: [Info@hbschombiz.com](mailto:Info@hbschombiz.com)

Web: [www.hbschombiz.com](http://www.hbschombiz.com)

Note: Product's specifications and information in brochure are subject to change without notice. Standard features and options may vary in some models. All dimensions & weights are subjects to tolerance of  $\pm 5\%$  information provided after considering ideal conditions for usage.